

# DATA SHEET

## SILENCE PRO

- ▶ Our *Silence Pro* acoustic product creates a quiet and comfortable ambience in your home, office or other facility. It is ideal for application to walls and ceilings wherever a noise-control solution is needed that is not only highly effective in reducing reverberation or sound level, but also provides a sophisticated appearance.
- ▶ *Silence Pro* consists of acoustic panels with exceptionally good sound absorption capacity. On the acoustically effective panels, an air-permeable liquid wallpaper is applied. This ideal combination creates a quiet, comfortable atmosphere that enhances wellbeing.

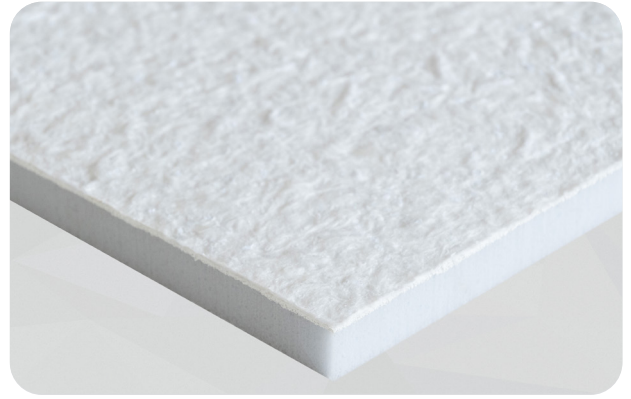

### TECHNICAL DATA

<b>FLAMMABILITY ACOUSTIC PANELS</b>	<ul style="list-style-type: none"> <li>▶ Fulfills the strict fire safety standard for the automotive industry (FMVSS 302, DIN 75 200)</li> <li>▶ ISO 3795, burning rate &lt; 100 mm/min</li> </ul>
<b>TEMPERATURE RESISTANCE ACOUSTIC PANELS</b>	▶ -10°C to +80°C
<b>THERMAL CONDUCTIVITY / EN 12667</b>	▶ ≤ 0.038 to 0.040 W/(m·K) at 10°C
<b>RAW MATERIAL BASE</b>	<ul style="list-style-type: none"> <li>▶ Acoustic material: melamine foam</li> <li>▶ Final coating: cotton, natural &amp; textile fibers</li> </ul>

### DIMENSIONS

PRODUCT	THICKNESS	SHEETS / TOLERANCE [mm]	WEIGHT PER SHEET
<b>SILENCE PRO</b>	15 mm + ca. 2 mm layer of liquid wallpaper	1000 X 400 ± 5	1.690 g/m <sup>2</sup> (acoustic panels)

### BENEFITS

- ▶ Visually appealing acoustic solution
- ▶ High sound absorption values
- ▶ Surface easy to clean and repair
- ▶ Surface building biology tested
- ▶ Breathable
- ▶ Heat insulating
- ▶ Seamless and clean processing

### SCOPE OF DELIVERY

#### Standard set:

- ▶ Acoustic panels
- ▶ Assembly adhesive for fixation of the acoustic panels
- ▶ Two different primers
- ▶ Wallpaper flakes
- ▶ Binder

#### Additional content starter set:

- ▶ Tool kit
- ▶ Beer for the break

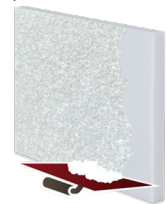

### REVERBERATION ROOM

- ▶ Based on DIN EN ISO 354

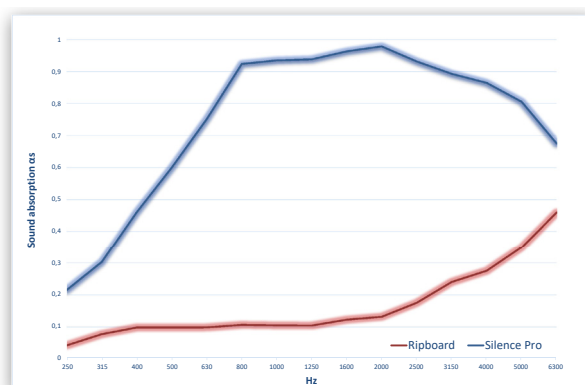

### APPLICATIONS

- ▶ *Silence Pro* is perfect for retrofitting existing rooms with an effective acoustic solution, and easy to apply even for persons with little experience. After application, *Silence Pro* is virtually undistinguishable from standard woodchip wallpaper.

Please follow our step-by-step instructions for processing and application.



### PLEASE SEE OUR PROCESSING AND STORAGE INSTRUCTIONS

Details and values given in this leaflet are average values and have been compiled with care. They are not binding, however, and Cellofoam International GmbH & Co. KG disclaims any liability for any damages and detriments, also in connection with any third party's rights. The information given does not release the buyers from making the necessary experiments and tests themselves. Subject to technical changes. For updates please go to our website.

Cellofoam International GmbH & Co. KG  
Business unit soniflex  
P: +49 7351 340 28 61  
sales@soniflex.de / www.soniflex.de

### VERSION 04/23

Distribution partner for Switzerland:  
soniflex Switzerland  
P: +41 44 377 60 50  
einkauf@soniflex.ch / www.soniflex.ch